

**Figure 1. Connection Diagram
(Pin Assignment for SOIC, SOP, SSOP, and TSSOP)**

74LCX245

ABSOLUTE MAXIMUM RATINGS

Symbol	Parameter	Condition	Value	Unit
V _{CC}	DC Supply Voltage		-0.5 to +6.5	V
V _I	DC Input Voltage (Note 1)		-0.5 to +6.5	V
V _O	DC Output Voltage (Note 1)	Active-Mode (High or Low State)	-0.5 to V _{CC} + 0.5	V
		Tri-State Mode	-0.5 to +6.5	
		Power-Down Mode (V _{CC} = 0 V)	-0.5 to +6.5	
I _{IK}	DC Input Diode Current	V _{IN} < GND	-50	mA
I _{OK}	DC Output Diode Current	V _{OUT} < GND	-50	mA
I _O	DC Output Source/Sink Current		±50	mA
I _{CC} or I _{GND}	DC Supply Current per Supply Pin or Ground Pin		±100	mA
T _{STG}	Storage Temperature Range		-65 to +150	°C
T _L	Lead Temperature, 1 mm from Case for 10 secs		260	°C
T _J	Junction Temperature under Bias		+150	°C
θ _{JA}	Thermal Resistance (Note 2)	WQFN20	99	°C/W
		TSSOP-20	150	
P _D	Power Dissipation in Still Air	WQFN20	1256	mW
		TSSOP-20	833	
MSL	Moisture Sensitivity		Level 1	-
F _R	Flammability Rating	Oxygen Index: 28 to 34	UL 94 V-0 @ 0.125 in	-
V _{ESD}	ESD Withstand Voltage (Note 3)	Human Body Model	2000	V
		Charged Device Model	N/A	

Stresses exceeding those listed in the Maximum Ratings table may damage the device. If any of these limits are exceeded, device functionality should not be assumed, damage may occur and reliability may be affected.

1. For more information on this parameter, please refer to the Absolute Maximum Ratings section of the 74LCX245 datasheet.

74LCX245

DC ELECTRICAL CHARACTERISTICS

Symbol	Parameter	Conditions	V	T _A = 40°C to +85°C	T _A = 40°C to +125°C	
--------	-----------	------------	---	--------------------------------	---------------------------------	--

				4.5 to 5.5	–	5.0	–	5.0		
t _{PZH} , t _{PZL}	Output Enable Time, OE to O	See Figures 5 and 6	1.65 to 1.95	–	13.0	–	13.0	ns		
			2.3 to 2.7	–	10.5	–	10.5			
			2.7	–	9.5	–	9.5			
			3.0 to 3.6	–	8.5	–	8.5			
			4.5 to 5.5	–	7.0	–	7.0			
t _p	isable E to O	See Figures 5 and 6	1.65 to 1.95	–	11.0	–	11.0	ns		
			2.3 to 2.7	–	9.0	–	9.0			
			2.7	–	8.5	–	8.5			
			3.0 to 3.6	–	7.5	–	7.5			
				4.5 to 5.5	–	6.0	–	6.0		
t _{OSHL} , t _{OSLH}	Output to Output Skew (Note 5)		1.65 to 1.95							

74LCX245

WQFN20 4.5x2.5, 0.5P
CASE 510CD
ISSUE O

DATE 31 AUG 2016

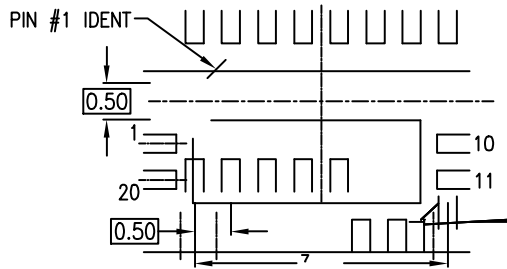
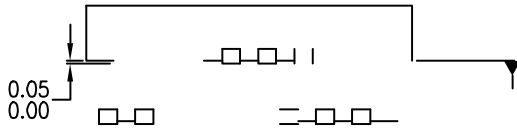
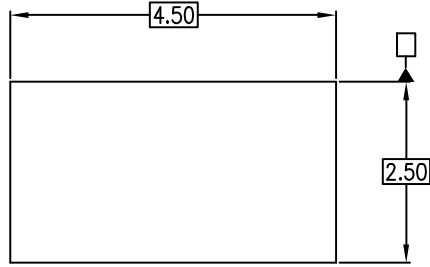

B. DIMENSIONS ARE IN MILLIMETERS.
C. DIMENSIONS AND TOLERANCES

TSSOP20, 4.4x6.5
CASE 948AQ
ISSUE A

DATE 19 MAR 2009

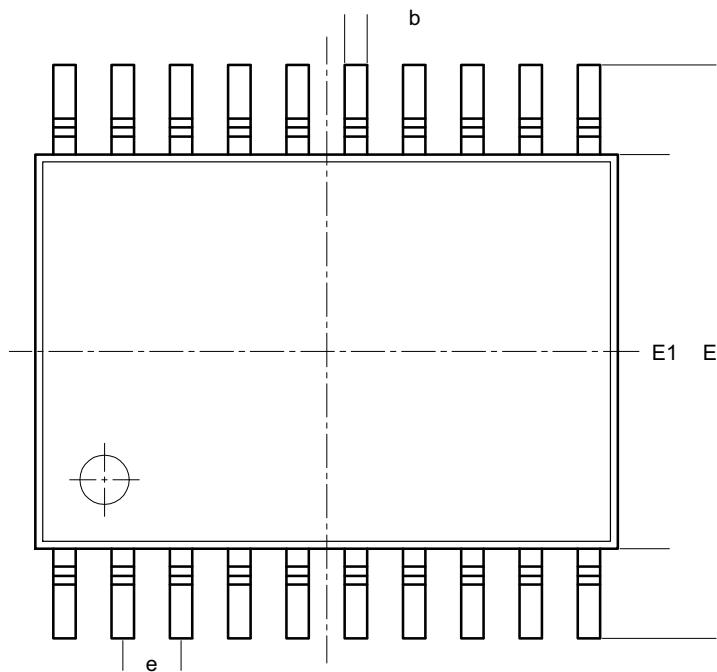

TOP VIEW

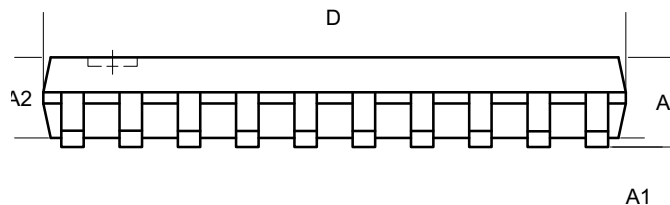

SIDE VIEW

SYMBOL	MIN	NOM	MAX
A			
A1			
A2			
b			
c			
D			
E			
E1			
e			
L1E1A2			
θ			

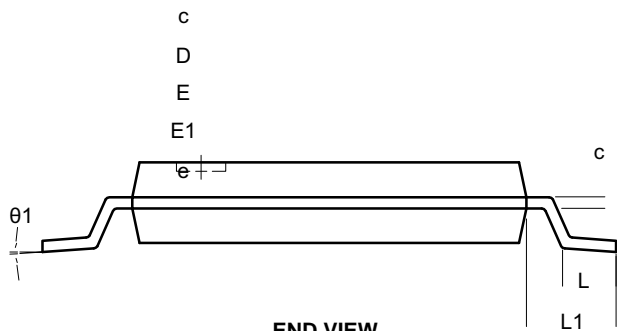

END VIEW

onsemi, **onsemi**, and other names, marks, and brands are registered and/or common law trademarks of Semiconductor Components Industries, LLC dba "**onsemi**" or its affiliates and/or subsidiaries in the United States and/or other countries. **onsemi** owns the rights to a number of patents, trademarks, copyrights, trade secrets, and other intellectual property. A listing of **onsemi**'s product/patent coverage may be accessed at www.onsemi.com/site/pdf/Patent-Marking.pdf. **onsemi** reserves the right to make changes at any time to any products or information herein, without notice. The information herein is provided "as-is" and **onsemi** makes no warranty, representation or guarantee regarding the accuracy of the information, product features, availability, functionality, or suitability of its products for any particular purpose, nor does **onsemi** assume any liability arising out of the application or use of any product or circuit, and specifically disclaims any and all liability, including without limitation special, consequential or incidental damages. Buyer is responsible for its products and applications using **onsemi**
