

CASE 340CZ  
ISSUE A

DATE 14 FEB 2020

DIMENSIONING PER ASME Y14.5M, 1994.

3. DIMENSIONS b, b1,b2,b3,b6 AND c TO BE MEASURED ON FLAT

1. DIMENSIONING AND TOLERANCE

TERMINALS AND EXPOSED PAD

6. A1 -

PLANE TO THE LOWEST POINT ON THE PACKAGE BODY.

7. DIMENSIONS D AND E TO BE DETERMINED AT DATUM PLANE C.

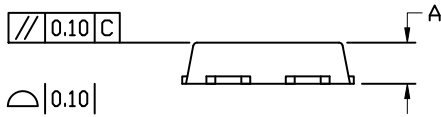
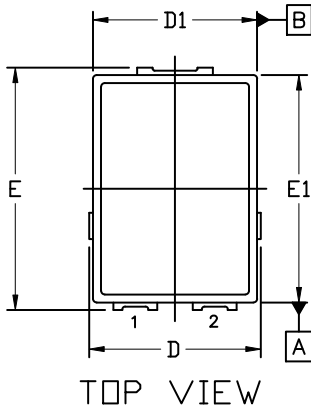

DIM	MILLIMETERS		
	MIN.	NDM.	MAX.
A	1.00	1.10	1.20
A1	---	0.01	0.05
b	1.13	1.18	1.28
c	0.20 REF		
D			
D1	4.35	4.40	4.45

DIM	MILLIMETERS		
	MIN.	NDM.	MAX.
L	0.90	1.05	1.20
L1	0.02		

RECOMMENDED  
MOUNTING FOOTPRINT

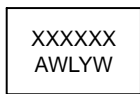

XXXXXX = Specific Device Code  
A = Assembly Location  
Y = Year  
W = Work Week  
WL = Wafer Lot

\*This information is generic. Please refer to device data sheet for actual part marking. Pb-Free indicator, "G" or microdot "▪", may or may not be present. Some products may not follow the Generic Marking.